

Professional  
**A-maxi**

**MADE IN TAIWAN**

High quality & Easy working  
Welcome To Visit Our Booth



**A-maxi**

▶▶ **LOCKING PLIERS**

# Locking Pliers

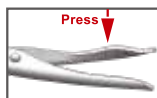

**American Type**  
Press lever to release

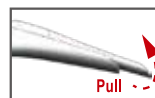

**European Type**  
Pull lever to release



**Easy Release Type**  
Push the lower handle to release

## Expanding Locking Pliers



### American Style & European Style

ITEM NO.	PA15-305XJ	5" / 125	23-45
	PA15-307XJ	7" / 175	28-60
	PA15-310XJ	10" / 250	33-76

### Easy Release Style

ITEM NO.	PA15-305XJAET	5" / 125	23-45
	PA15-307XJAET	7" / 175	28-60
	PA15-310XJAET	10" / 250	33-76



### \*Jaw supply steady expanding power

Flexible expanding size setting by expanding screws and locking nut allows various expanding actions.

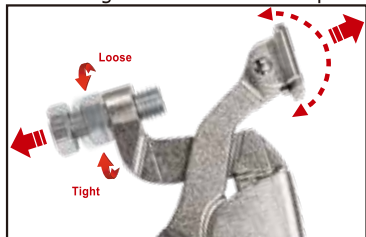

## 4th Automatic Generation Locking Pliers

### Lock automatically without jaw adjusting

The automatic locking grip can provide a strong grip on your working pieces automatically without adjusting the wideness of the jaw.

### Pressure setting

The knurling tension screw can easily set desired clamp pressure from slight to extreme depending on your needs.

### Easy release operation

Brand New structure of easy release handle improves the operation more quickly and more easily

TPR material grip provides comfortable holding touch, and grain-shape design effectively prevent slipping as use.

ITEM NO.	PA15-T305BET	6" / 150	25
	PA15-T310BET	10" / 250	38

ITEM NO.	PA15-T310RBET	10" / 150	38
----------	---------------	-----------	----

ITEM NO.	PA15-T306BET	7" / 175	25	4.5 / 7
----------	--------------	----------	----	---------

ITEM NO.	PA15-T306RBET	7" / 230	50	71	68
	PA15-T309CBET	10" / 290	80	71	129
	PA15-T311RBET	11" / 330	72	100	95

ITEM NO.	PA15-T306PBET	7" / 230	50	70	58
	PA15-T309CPBET	10" / 290	80	70	120
	PA15-T311PBET	11" / 330	72	100	85



## Locking C-Clamps EUR Series



### European Style

ITEM NO.	PA15-403CL	8" / 195	70	30
	PA15-403CLW	9" / 230	70	60
	PA15-405CLW	9" / 230	150	60



### \*Quick Size Adjusting

Flexible clamping size directly setting by adjusting bolts allows various clamping actions



### \*Extreme Clamping Capacity

Constructed of heat-treated Chrome Molybdenum alloy steel gives maximum durability gripping power. Max. clamping capacity 70-150mm.

### \*U Shaped Arms

U shaped arms allow to clamp variety shapes materials while providing greater versatility.

Suitable for welding, wood working, carpenter, engineer, and etc.



### \*Squeeze To Lock, Pull Up To Loosen

Unique design of European handle.

Simply squeeze the handle to lock and pull up the release lever to loosen.



## Classic Locking Pliers with Scangrip Handle

### \*Especially for Scandinavia market!



Use a hex wrench for quick adjustments

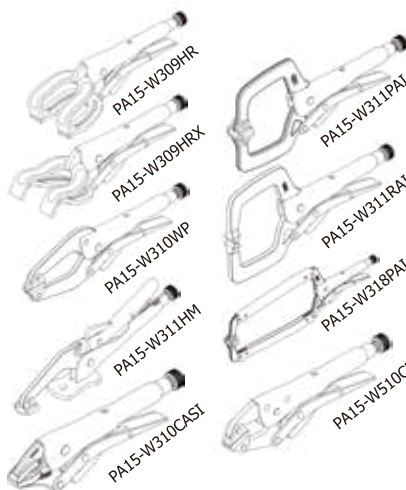

ITEM NO.	PA15-W310CASI	10" / 250	48
	PA15-W510CP	10" / 250	30
	PA15-W311RAI	11" / 275	88
	PA15-W311PAI	11" / 275	89
	PA15-W309HRX	10" / 280	65
	PA15-W311HM	11" / 275	90
	PA15-W310WP	10" / 280	100
	PA15-W318PAI	18" / 455	208
	PA15-W309HR	10" / 255	31-60

### \*One hand operation, it is convenient to use.

Classic handle design meets customers' habits to use this plier series. By press the handle to open the locking pliers and squeeze to clamp object. Just press the handle to open quickly!

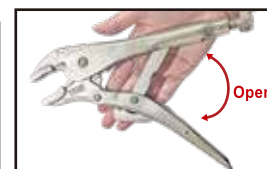



Welding



Automotive



Industry



Woodwork



Maintenance



Building

# Professional A-max®

## Table C-Clamps



American Style



ITEM NO.			
PA15-311HM	11" / 275	90	80
PA15-311PHM	11" / 275	80	75
PA15-314PHM	14" / 355	120	150

## T Slot Clamp With Pipe



American Style



Ø28mm

ITEM NO.				
PA15-311HP	11" / 275	105	Ø28	150
PA15-311PHP	11" / 275	85	Ø28	150
PA15-314PHP	14" / 355	105	Ø28	150

## Axial Welding Pliers



Self-locking multi-grip plier Wide flat jaws



ITEM NO.		
PA15-528W	8" / 200	10

Self-locking multi-grip plier Double curved jaws



ITEM NO.		
PA15-525JJ	9" / 225	10

Self-locking multi-grip plier Wide curved jaws



ITEM NO.		
PA15-515LL	8" / 200	15

## Table C-Clamps



American Style



NEW

ITEM NO.				
PA15-311RHM	11" / 275	75	75	

## Drill Press Clamp



American Style



M10

ITEM NO.				
PA15-311SHP	11" / 275	85	10	50

## Axial Welding Pliers



Self-locking multi-grip plier Flat jaws set at 90° angle



ITEM NO.		
PA15-518T	7" / 175	15

Self-locking multi-grip plier Angled jaws



ITEM NO.		
PA15-522J	8" / 200	10

Self-locking multi-grip plier Straight jaws



ITEM NO.		
PA15-512L	7" / 175	15

## 90° Corner Woodwork Clamp



American Style



ITEM NO.		
PA15-309CS	9" / 255	1" / 25.4

NEW

**\*Quickly assemble and fix the 90° shelf**

Suitable for 90° angle and "T" shaped joints. Pull the drawer box into the aligned position quickly and easily.

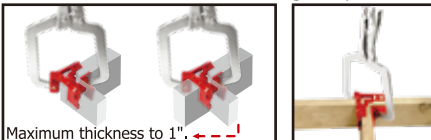

Maximum thickness to 1"

**\*Two-way switching**

Patented strut can be flipped quickly and easily to work on next corner.

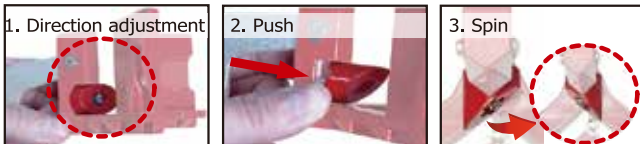

**\*The Cutout allows to put pocket screw**

The cutout in the pads allows to put pocket screws in place without undoing the clamp.



## 2-Way Right Angle Woodwork Clamp



American Style



ITEM NO.				
PA15-309TF	9" / 250	38~65	2" / 50	

NEW

**\*Strong Adjustable Clamping Force**

This clamp can work as Right Angle Clamp & C-Clamp. The steel pin on this clamp is shaped to fit snugly into a pocket hole, securely anchoring one workpiece against the other for easy assembly.

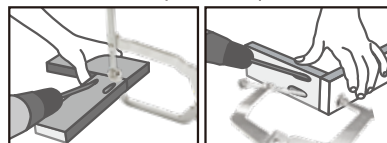

**\*Multi-purpose 90°**

2-way clamps can work as right angle clamps or C-Clamps, which keep pocket holes secure and square at 90° degrees during project assembly and effective clamping.

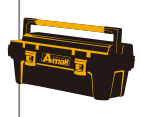
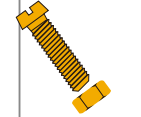
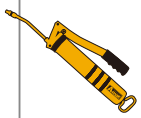
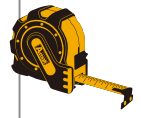
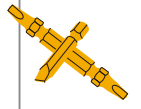
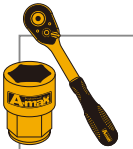
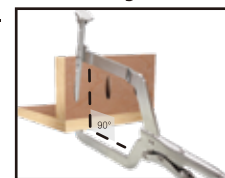

# Locking Pliers

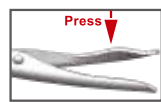

**American Type**  
Press lever to release

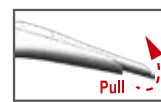

**European Type**  
Pull lever to release



**Easy Release Type**  
Push the lower handle to release

## Product Features

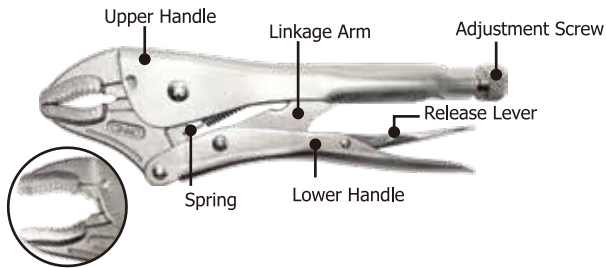

**1. Screw w/a hole**  
5" Screw w/a hole, within Ø5mm  
7" & 10" Screw w/a hole, within Ø7mm



**2. Screw w/inner hex on hole**  
4" & 5" Screw w/inner hex on head, within Ø3mm  
7" Screw w/inner hex on head, within Ø4mm  
10" Screw w/inner hex on head, within Ø5mm

## Optional Accessories



**Release Lever Grip**  
Available for American and European Type



**Upper Handle Grip**  
Available for American, European, Easy Release Type



**Bottom Handle Grip**  
Available for Easy Release Type

## Curved Jaw Locking Pliers



### American Style & European Style

ITEM NO.	Length	Weight
PA15-304ASI	4" / 100	25
PA15-305ASI	5" / 125	26
PA15-307ASI	7" / 175	41
PA15-310ASI	10" / 250	53
PA15-312ASI	12" / 300	60

### Easy Release Style

ITEM NO.	Length	Weight
PA15-305ASET	5" / 125	26
PA15-307ASET	7" / 175	41
PA15-310ASET	10" / 250	53



With Wire Cutter



## Curved Jaw Locking Pliers



### American Style & European Style

ITEM NO.	Length	Weight
PA15-305CASI	5" / 125	26
PA15-307CASI	7" / 175	43
PA15-310CASI	10" / 250	48
PA15-312CASI	12" / 300	60

### Easy Release Style

ITEM NO.	Length	Weight
PA15-305CASET	5" / 125	26
PA15-307CASET	7" / 175	43
PA15-310CASET	10" / 250	48



Without Wire Cutter



## X-Jaw Locking Pliers



### American Style & European Style

ITEM NO.	Length	Weight
PA15-307XA	7" / 175	45
PA15-310XA	10" / 250	50

### Easy Release Style

ITEM NO.	Length	Weight
PA15-307XAET	7" / 175	45
PA15-310XAET	10" / 250	50



## Straight Jaw Locking Pliers



### American Style & Easy Release Style

ITEM NO.	Length	Weight
PA15-305RASI	5" / 125	23
PA15-307RASI	7" / 175	33
PA15-310RASI	10" / 250	43

### European Style

ITEM NO.	Length	Weight
PA15-305RASIE	5" / 125	23
PA15-307RASIE	7" / 175	33
PA15-310RASIE	10" / 250	43
PA15-312RASIE	12" / 300	65



## Long Nose Locking Pliers



### American Style & European Style

ITEM NO.	Length	Weight
PA15-304LA	4" / 100	44
PA15-306ASI	6" / 150	52
PA15-309ASI	9" / 225	73

### Easy Release Style

ITEM NO.	Length	Weight
PA15-306ASET	6" / 150	52
PA15-309ASET	9" / 225	73



With Wire Cutter



## Round Jaw Locking Pliers



### American Style

ITEM NO.	Length	Weight
PA15-307N	7" / 175	11~21
PA15-310N	10" / 250	15~27

### European Style

ITEM NO.	Length	Weight
PA15-307NE	7" / 175	11~21
PA15-310NE	10" / 250	15~27



With Wire Cutter



## Round Jaw Locking Pliers



### American Style

ITEM NO.	Length	Weight
PA15-304N	4" / 100	7~16

### European Style

ITEM NO.	Length	Weight
PA15-304NE	4" / 100	7~16



With Wire Cutter



## V Jaw Locking Pliers



### American Style & European Style

ITEM NO.	Length	Weight
PA15-307EEAI	7" / 175	40
PA15-310EEAI	10" / 250	43
PA15-312EEAI	12" / 300	70

### Easy Release Style

ITEM NO.	Length	Weight
PA15-307EEAET	7" / 175	40
PA15-310EEAET	10" / 250	43



## W Jaw Locking Pliers



### American Style & European Style



ITEM NO.	PA15-310CV	10" / 250	66	55

### Easy Release Style



ITEM NO.	PA15-310CVAET	10" / 250	66	55

## Lift Support Pliers



### American Style



ITEM NO.	PA15-304AL	4" / 100	18



## Hose Clamp Locking Pliers



### American Style & European Style



ITEM NO.	PA15-306HCX	6" / 150	37



### Easy Release Style

ITEM NO.	PA15-306HCXAET	6" / 150	37

## Bet Series Locking Pliers



### Easy Release Style



ITEM NO.	PA15-310BET	10" / 250	53

**NEW**

### \*Ergonomic handle

Is not only to consider the product shape, but also focus on the steady holding force and comfort. In this case, it will improve the work efficient and prevent the damage due to tired holding during long-time work.

### \*Improved construction

Reduce 20% handle-holding margin to release the bearing of hand.

### \*Adjustment Knob

Adjustment Knob with inner hex holes permits to speed the fitting of expanding size by cooperating with L-key.

### \*Release Force Saving

Not only save 60% release force during the work, but also relax the tired holding of hands.

### \*Clamping Force Upgraded

User could hold the pliers firmly due to the 20% holding-gap saving. And the clamping force increases 15% compared to 1st generation.

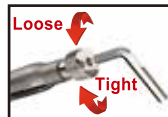

## Large Jaw Locking Pliers



### American Style & European Style



ITEM NO.	PA15-312LJ	12" / 300	96

### Easy Release Style



ITEM NO.	PA15-312LJAET	12" / 300	96

## Large Jaw Locking Pliers



### American Style & European Style



ITEM NO.	PA15-311ASL	10" / 250	51	6.5	15

### Easy Release Style

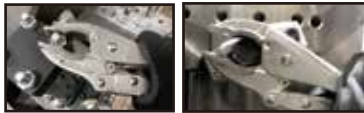

ITEM NO.	PA15-311ASET	10" / 250	51	6.5	15

## Oil Filter Master Pliers



### American Style



ITEM NO.	PA15-306MP	10" / 250	55-110

### European Style



ITEM NO.	PA15-306MPE	10" / 250	55-110



Bent (Angle: 23°) model is ideal for a limit space

## Locking Tools Holder



**NEW**

ITEM NO.	PA15-G410	137	75	25

### \*Washer

Washer ensures a firm hold on almost any work surface, without leaving scratch on it.

### \*Holding Mechanism

Quickly and easily attaches to workbench or other flat surface. Hold 5-inch, 7-inch and 10-inch locking pliers.

### \*Adjusting Screws

Thanks to the 4 adjusting screws, even 5-in locking pliers can be put in without gap.

### \*Triangular Eye Thumb Lock Bolt

Thumb grip to help fastening. It can be used powerfully with a screwdriver.

With 2 or more installed, sticks, bars, tubes or pipes in long length and even in different thickness can be easily clamped steadily. Then you can do the welding, sawing, or cutting work efficiently.



## Locking Chain Wrenches



### American Style

ITEM NO.			
PA15-320R	9" / 225	500	
PA15-323R	9" / 225	600	



### European Style

ITEM NO.			
PA15-320RE	9" / 225	500	
PA15-323RE	9" / 225	600	

## Cutting Chain Wrenches



### American Style

ITEM NO.			
PA15-513RC	9" / 225	290	
PA15-523RC	9" / 225	350	



### European Style

ITEM NO.			
PA15-513RCE	9" / 225	290	
PA15-523RCE	9" / 225	350	

## Automatic Curved Jaw Locking Pliers



ITEM NO.			
PA15-T305A	6" / 150	25	
PA15-T308A	8" / 220	30	
PA15-T310A	10" / 250	38	



With Wire Cutter

## Automatic Straight Jaw Locking Pliers



ITEM NO.			
PA15-T308RA	8" / 220	30	
PA15-T310RA	10" / 250	38	



Straight Jaw

## Automatic Long Nose Jaw Locking Pliers



ITEM NO.				
PA15-T306A	7" / 175	25	4.5	7



## Automatic Welder's Grip Wrench



ITEM NO.				
PA15-T309RS	9" / 225	40	30	65



## Automatic Locking C-Clamps



ITEM NO.					
PA15-T306RA	7" / 230	50	71	68	
PA15-T309CR	10" / 290	80	71	129	
PA15-T311RA	11" / 330	72	100	95	
PA15-T318RA	19" / 455	200	107	269	



## Automatic Locking C-Clamps



ITEM NO.					
PA15-T306PA	7" / 230	50	70	58	
PA15-T309CP	10" / 290	80	70	120	
PA15-T311PA	11" / 330	72	100	85	
PA15-T318PA	19" / 455	200	107	250	



## Automatic Screw Removal Locking Pliers



ITEM NO.				
PA15-T305M	6" / 150	31	Ø3-9.5	



With Wire Cutter



### \*Vertical serrations in the center

Pliers have specially shaped jaws with vertical and arch-lined serrations, which results in NO slippage when twisting the screw out.

### \*Grip & remove a stuck screw

The unique tip shape also supports low-head screws(truss screws). Since the vise mechanism grabs and locks the screw, even a tightly tightened screw can be turned with less force.

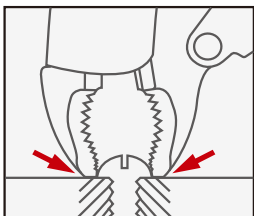

The vertically-serrated gripping surface holds screws firmly and securely for problem-free extraction.

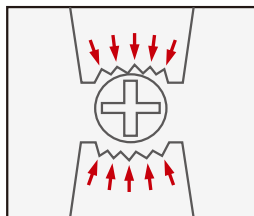

Specially-designed teeth generate gripping power, so no slippage.

## Screw Removal Locking Pliers



### Easy Release Style

ITEM NO.				
PA15-305MET	5" / 125	26	Ø3-9.5	
PA15-307MET	7" / 175	41	Ø7-12	



With Wire Cutter

### How to use



#### Step 1:

Loosen the adjusting screw to make the jaws fitting the diameter of screw.



#### Step 2:

Fasten the adjusting screw 90°~180° clockwise.(Half a turn to the right)



#### Step 3:

Squeeze the handles to lock the jaws. Turn and loosen the screw.

### \*Grip & remove a stuck screw

The unique tip shape also supports low-head screws(truss screws). Since the vise mechanism grabs and locks the screw, even a tightly tightened screw can be turned with less force.





Welding



Automotive



Industry



Woodwork



Maintenance



Building

# Professional A-max®

## Locking Panel Clamps



■ American Style



ITEM NO.				
PA15-309USR	9" / 225	10	68	



## Welder's Grip Wrenches



■ American Style & European Style



ITEM NO.				
PA15-309RS	9" / 225	45	66	69
PA15-309RAI	11" / 275	52	70	69



■ Easy Release Style

ITEM NO.				
PA15-309RSAET	9" / 225	45	66	69
PA15-309RAET	11" / 275	52	70	69

## Sheet Metal Grips



■ American Style & European Style



ITEM NO.				
PA15-308RS	8" / 200	39	79.5	
PA15-308RAI	10" / 250	45	79.5	



■ Easy Release Style

ITEM NO.				
PA15-308RSAET	8" / 200	39	79.5	
PA15-308RAET	10" / 250	45	79.5	

## Pinch Off Locking Pliers



■ American Style



ITEM NO.		
PA15-307RR	7" / 175	29

■ European Style

ITEM NO.		
PA15-307RRE	7" / 175	29



## Angle Nose Hose Pinch Pliers



■ American Style



ITEM NO.				
PA15-309LR	11" / 275	43	123	80

■ European Style

ITEM NO.				
PA15-309LRE	11" / 275	43	123	80



## Locking C-Clamps



■ American Style & European Style



ITEM NO.				
PA15-306RAI	6" / 150	36	60	35
PA15-309CR	9" / 225	101	80	120
PA15-311RAI	11" / 275	88	90	75
PA15-318DR	18" / 455	178	190	245
PA15-318RAI	18" / 455	163	100	250
PA15-324RAI	24" / 610	300	80	395

■ Easy Release Style

ITEM NO.				
PA15-306RAET	6" / 150	36	60	35
PA15-311RAET	11" / 275	88	90	75
PA15-318RAET	18" / 455	163	100	250



## Welder's Grip Wrenches Pipe Working



■ American Style



ITEM NO.				
PA15-309RXAI	11" / 275	75	75	68

■ European Style

ITEM NO.				
PA15-309RXAIE	11" / 275	75	75	68



## Roofers Welder Grip Wrench



■ American Style



ITEM NO.		
PA15-308RST	8" / 200	7

■ European Style

ITEM NO.		
PA15-308RSTE	8" / 200	7



## Straight Nose Hose Pinch Pliers



■ American Style



ITEM NO.				
PA15-309RR	11" / 275	114	123	80

■ European Style

ITEM NO.				
PA15-309RRE	11" / 275	114	123	80



## Locking C-Clamps With PVC Covered



■ American Style



ITEM NO.		
PA15-311DH	11" / 285	78



## Stepped C-Clamp



■ American Style & European Style



ITEM NO.				
PA15-5150	10" / 288	80-150	145	70
PA15-5230	10" / 288	150-230	210	70
PA15-5300	10" / 288	230-300	295	70

■ Easy Release Style

ITEM NO.				
PA15-5150AET	10" / 288	80-150	145	70
PA15-5230AET	10" / 288	150-230	210	70
PA15-5300AET	10" / 288	230-300	295	70



## Locking C-Clamps



■ American Style & European Style



ITEM NO.				
PA15-304PAI	4" / 100	26	45	25
PA15-306PAI	6" / 150	36	60	35
PA15-309CP	9" / 225	88	80	110
PA15-311PAI	11" / 275	89	90	75
PA15-314PAI	14" / 355	110	90	150
PA15-318PAI	18" / 455	208	90	240
PA15-324PAI	24" / 610	304	80	405

■ Easy Release Style

ITEM NO.				
PA15-306PAET	6" / 150	36	60	35
PA15-311PAET	11" / 275	89	90	75
PA15-318PAET	18" / 455	208	90	240

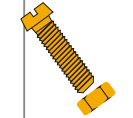
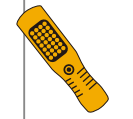
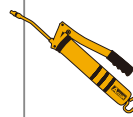
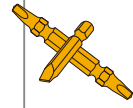
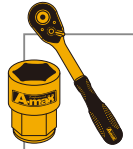

# German Type

High clamping pressure due to toggle lever action

## \*Adjustment Knob

Knob with knurling texture allows to adjust the jaw capacity and locking pressure easily even wearing gloves or having slippery hands. Screw in to increase the pressure or enlarge the jaw size. Can be retightened with a hex key wrench.



## \*Pull the Release Lever to loosen

Simply pull the release lever upwards motion to loosen the bite quickly and easily and straight to move on to your next work directly without readjusting jaw opening even if the works' thickness are different.



## Curved Jaw German Type



ITEM NO.	in / mm	mm
PA15-310EASI	10" / 250	53
PA15-312EASI	12" / 300	70

## V Jaw Locking Pliers



ITEM NO.	in / mm	mm
PA15-307EEAIE	7" / 175	40
PA15-310EEAIE	10" / 250	43
PA15-312EEAIE	12" / 300	70

## Parallel Plus Grip Pliers



ITEM NO.	in / mm	mm
PA15-310SWE	10" / 236	48

## Welder's Grip Wrenches



ITEM NO.	in / mm	mm	mm	mm
PA15-309HRE	10" / 255	31~60	75	74

## Welder's Grip Wrenches Pipe Working



ITEM NO.	in / mm	mm	mm	mm
PA15-309HRXE	10" / 280	65	75	74

# French Type



Sliding & Adjustable Jaw Locking Pliers

The big adjustable knob for quick and easy move to different position

Knurled screw for precise adjustment

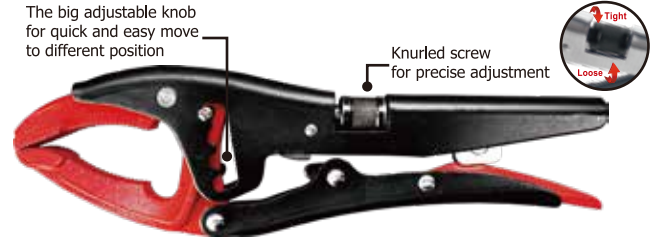

4-Position slip joint for prompt adjustment of jaw capacity. One handed operation- Quick release system by release lever. Safety lock system to prevent accidental release. Knurled screw for precise jaw adjustment. Forged and hardened jaws with heavy duty grooves for consistent clamping.

## \*Press the Release Lever to loosen

Simply press the release lever upwards to loosen quickly and easily.



## French Type Adjustable Jaw Locking Pliers

### ■ Straight Jaw



ITEM NO.	in / mm	mm
PA15-4036	10" / 250	95

### ■ Curved Jaw



ITEM NO.	in / mm	mm
PA15-4037	10" / 250	80

### ■ Large Jaw



ITEM NO.	in / mm	mm
PA15-4139	12" / 300	93

### ■ Curved Jaw With Swivel Pads - 2 Way



ITEM NO.	in / mm	mm
PA15-4038	10" / 250	80



Swivel Jaws



Fixed Jaws

## VVE Jaw Locking Pliers



ITEM NO.	in / mm	mm
PA15-310VVE	10" / 250	48

## Angled Grip Wrench



ITEM NO.	in / mm	mm
PA15-307SE	7" / 195	51

# A-max

International Co., Ltd.

886-4-2383 0286

amax@amaxtools.com

886-4-2383 0287

www.amaxtool.com

A-max

YouTube

